

DECENTRALIZED HOME VENTILATION LG 100



**COMFORT
VENTILATION**



EPREL according
to Regulation (EU)
No. 1369/2017



 **PICHLER**

Systematic ventilation.

Product description

With its flexible mounting options and connection variants the decentralized compact ventilation unit LG 100 offers an optimum solution for every situation. Depending on the design of the housing, the following installation variants are provided for selection: Installation of the ventilation unit in the exterior wall (flush-mounted approach), installation on the inner side of an exterior wall (surface-mounted approach), or installation in a suspended ceiling (ceiling approach). The flush-mounted approach can be optionally implemented as single-room or multi-room application.

With the LG 100 ventilation unit the ventilation concept can be created very flexibly and, if required, further rooms can be integrated via the KomFlex® air duct system. By means of small, adjustable sliding elements, the supply air and extract air volume flows that are led via the front cover of the unit can be regulated.

The used air is extracted from the living areas, and fresh, filtered outdoor air is supplied again. In this process, the high-quality enthalpy exchanger allows

for efficient heat and moisture recovery and ensures a well-balanced room humidity and a pleasant room climate.

Highly efficient and low noise EC radial fans allow for extremely energy-saving and low-noise operation. In the switched-off state, the outdoor and exhaust air openings are automatically closed mechanically. The integrated sensors record the VOC and eCO₂ concentration of the extract air and, in automatic mode, allow for an operation depending on the room air quality.

The decentralized compact ventilation unit LG 100 is operated easily and intuitively via push button directly at the unit or via the Pichler App. To make this possible, one of the unit's standard features is the WLAN connection. Optionally you can additionally connect an external control unit via cable connection. Optionally you can additionally connect an external control unit via cable connection.

Optionally: Different designs and colours of the design front available on request, standard colour RAL 9003.

GLA function (basic ventilation active)

The ventilation units can already be preconfigured with the GLA function (basic ventilation active) by the factory so that they meet the requirements of DIN 18017-3. It is not possible to switch off the unit via the operating buttons or the Pichler App. Neither can continuous operation be carried out at the basic ventilation level whilst the GLA function is activated.

If the automatic mode is selected, the unit regulates between the preset volume flow rates, between basic ventilation and level 3, automatically and as a function of the extract air quality properties (VOC, eCO₂ and humidity). As an alternative, continuous operation at level 2 (normal ventilation) or level 3 (boost ventilation) can be carried out.

Area of application

The unit is ideally suitable for the controlled home ventilation of small to medium-sized residential units. The variant variety offers the perfect solution for any mounting conditions.

For new buildings, for instance, the flush-mounted approach is especially suitable, allowing to "hide" the ventilation unit almost flush with the exterior wall.

Apart from the aeration and ventilation of the room in

which the unit is installed, additional supply air and extract air rooms can be connected.

For renovations in existing buildings, we recommend the surface-mounted installation type. This type of installation only requires two core drillings (Ø 142 mm). As an alternative, the unit can also be mounted on the ceiling. A suspended ceiling of 200 mm hides the built-in frame and the pipes.

System solution for residential building

BENEFITS

- Decentralized ventilation unit with optional multi-room connections
- Flush-mounted, on-wall or ceiling variant
- Intelligent humidity control
- Silent and efficient comfort ventilation
- High acoustic insulation
- Two-stage outdoor air filtration
- Without condensate drainage by enthalpy exchangers
- Cover flaps for outdoor air/exhaust air
- VOC/eCO₂ multi-sensor for room air quality measurements integrated
- Allocation of the operating & maintenance expenses by individual apartments
- Installation into the exterior wall makes it possible to dispense with risers
- No penetration of fire compartments in residential buildings
- WLAN connection. The ventilation unit only supports the WiFi/WLAN standard 2.4 GHz.
- Operation via the Pichler App



Special features

ENTHALPY EXCHANGERS

are recuperative energy exchangers not only recovering heat, but also humidity and in this way providing for a balanced room climate throughout the year. This is enabled by a special polymer membrane which allows for vapour diffusion, but at the same time prevents the formation of bacteria (hygiene-certified in compliance with VDI 6022). The enthalpy exchanger does not produce any condensate and it convinces by its long lifetime at excellent transmission values.

FILTER

A special focus is placed on the filtration of the outdoor air. The outdoor air is filtered in two stages so as to create filter change intervals that are as long as possible and nevertheless provide for a high separation efficiency. Even with a higher fine dust pollution, effective and efficient filtration is therefore ensured.

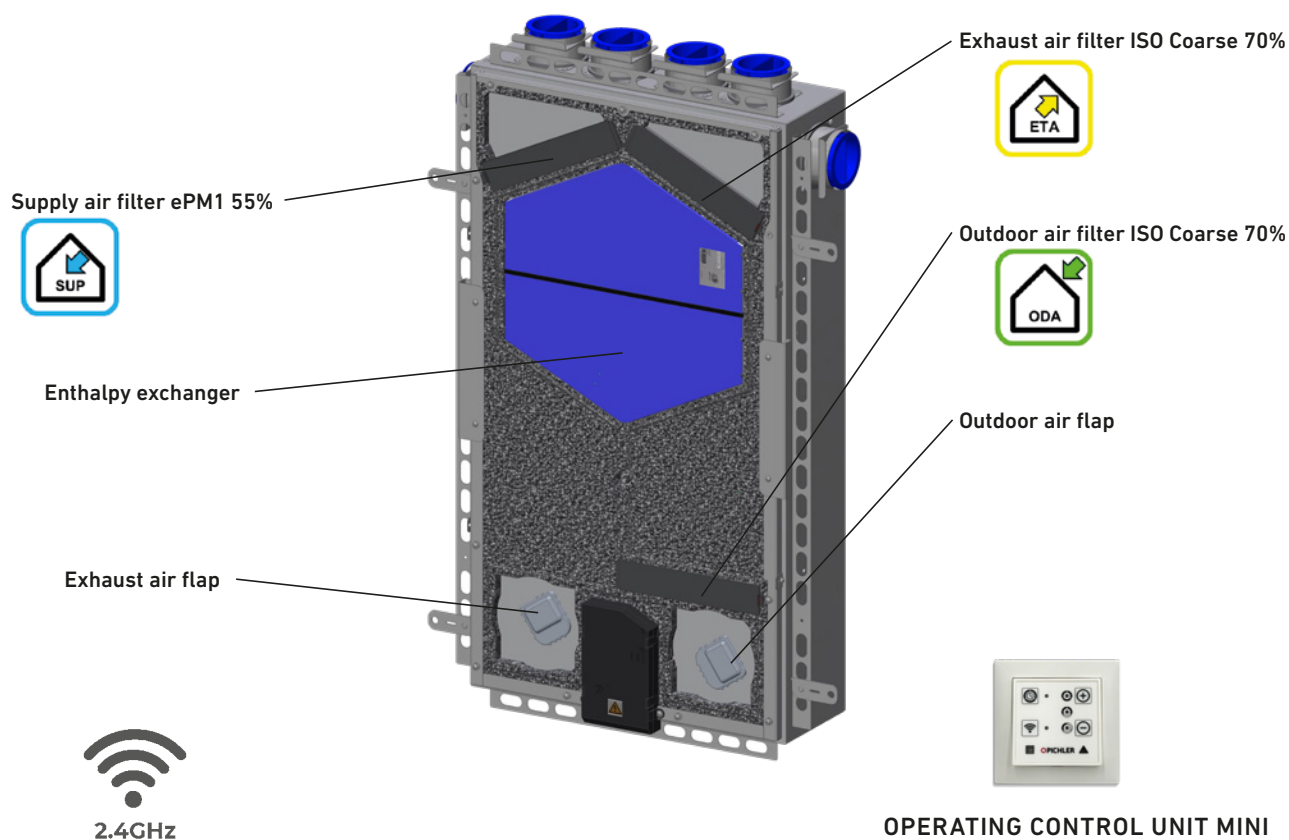

WLAN / PICHLER APP

The ventilation unit can be easily integrated into the home network and controlled via the Pichler App. Download in the Apple iOS store and Google Play store.
To ensure a stable WLAN connection of the LG 100 it may be required to boost the WLAN signal by using WLAN repeaters or to establish a mesh network.



CONTROL

The demand-driven volume flow control is based on the continuous measurement of the room air quality. When the VOC or eCO₂ concentration rises, the volume flow is automatically increased. If outdoor temperatures are very low, depending on the design either the pre-heating battery is activated or the supply air volume flow is reduced.

If operation via Pichler App and by means of the push button on the unit is not sufficient (e.g. in the case of ceiling mounting), you can optionally connect the wired operating control unit MINI. It is easy to handle, makes it possible to adjust the ventilation levels and displays the operating status, a necessary filter change and possibly occurring faults. It is installed on a flush-mounted socket.



Flush-mounted fitting – single-room application (recommended operating volume flow: 20 – 60 m³/h)

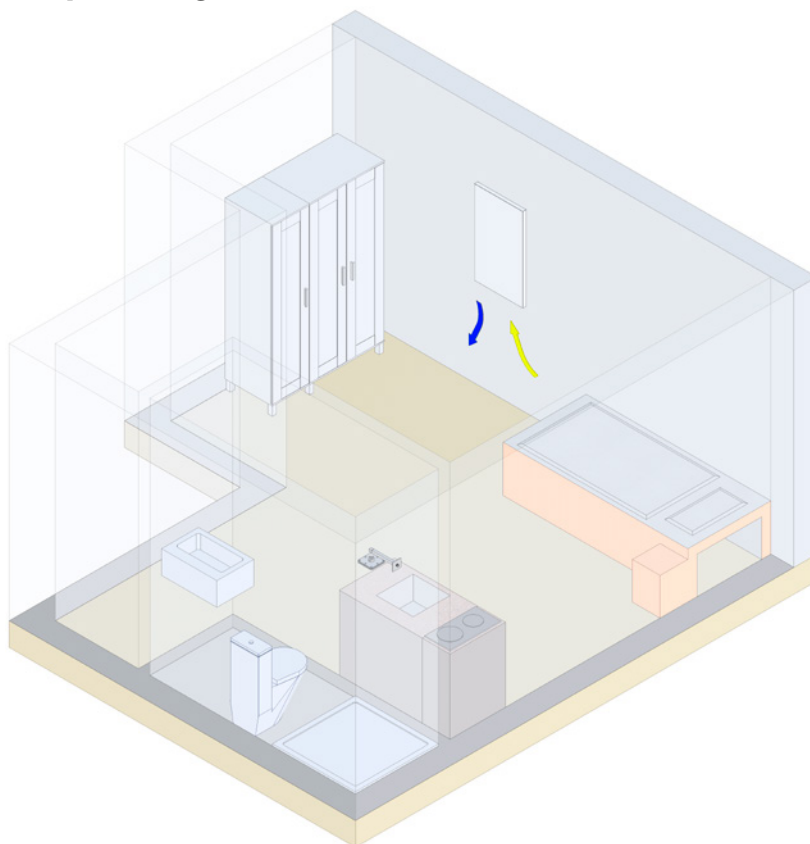

THE FOLLOWING ARTICLES ARE COMBINED FOR SINGLE-ROOM APPLICATIONS AS A STANDARD

The flush-mounted housing (3), the EPS compensating insulation (4) and the EPP wall duct element (5) are already required in the shell construction phase. The remaining articles are installed at a later time in the completion phase.

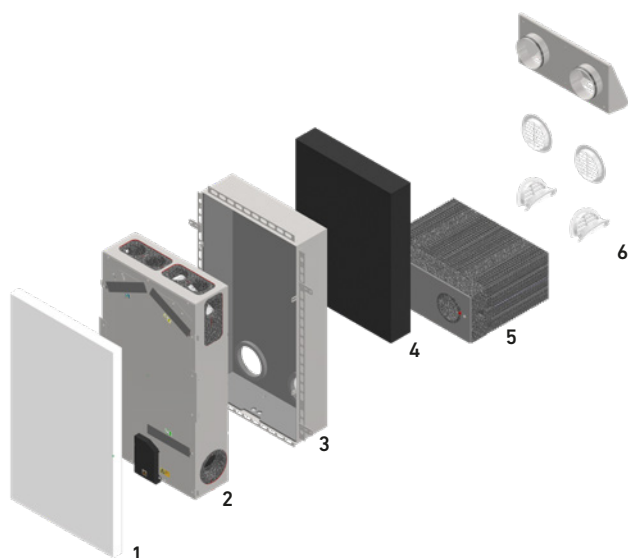

Item	Item number
1 Design front, RAL 9003, other designs and colours – see page 25	08LG100UPAPDF1A
2 Compact ventilation unit LG100 without housing	
a without pre-heater battery	08LG100UPF
b without pre-heater battery, GLA*	08LG100UPFGLA
c with pre-heater battery	08LG100UPFV
d with pre-heater battery, GLA*	08LG100UPFVGLA
3 Flush-mounted housing, single-room application	08LG100UPGERA
4 EPS compensating insulation, 100 mm	08LG100UPAGD1A
5 EPP wall duct element	08LG100UPWD
6 Facade end	
a Outside wall element NW125, V2A	08AWESV2A125
b Outside wall element NW125, galvanized steel, RAL9003**	08AWES125
c Plastic grille NW 80 to 125, white, mountable from the outside	10TU125B
d Plastic grille NW 100 to 140, white, mountable from the inside	10DF140B

* Basic ventilation always active, cannot be switched off (DIN18017-3)

** Other colours on request



FLUSH-MOUNTED HOUSING, SINGLE-ROOM APPLICATION (3)

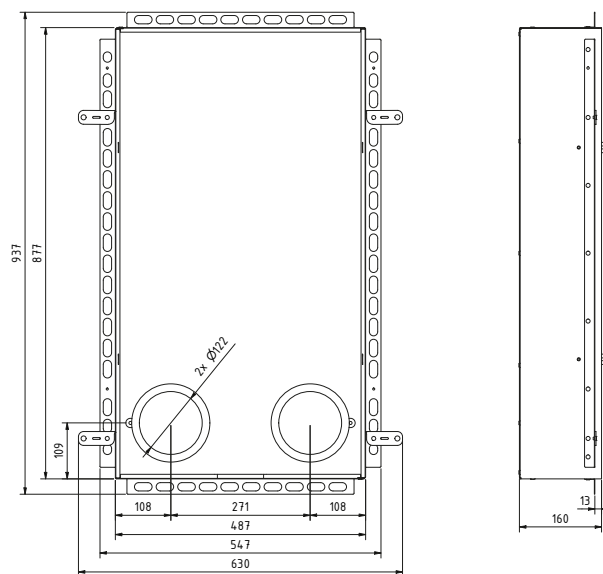
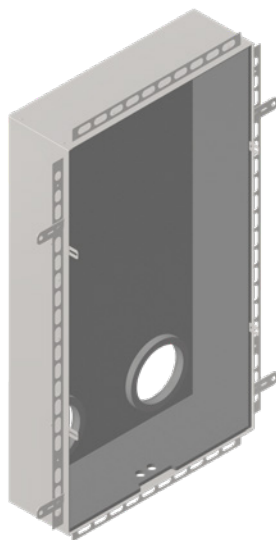

EPS COMPENSATING INSULATION (4)

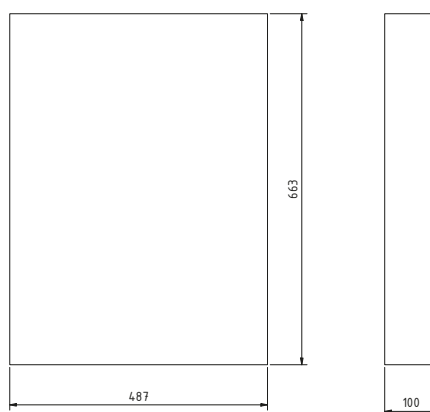
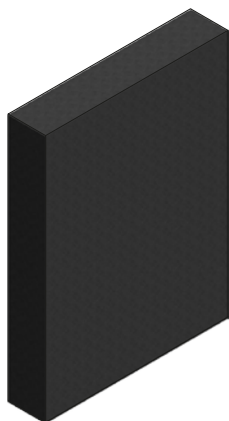

EPP WALL DUCT ELEMENT (5)

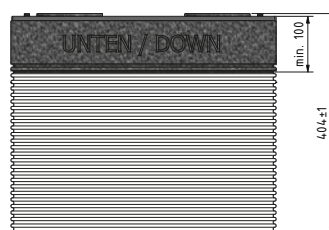
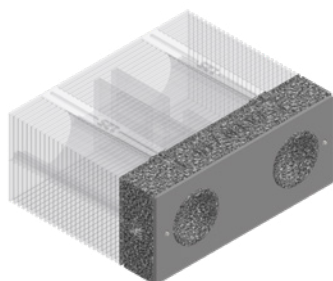

Can be shortened to a minimum of 100 mm

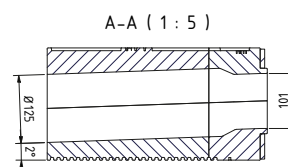
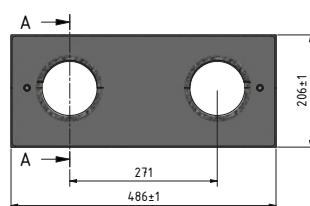

Flush-mounted fitting – multi-room application (recommended operating volume flow: 20 – 80 m³/h)

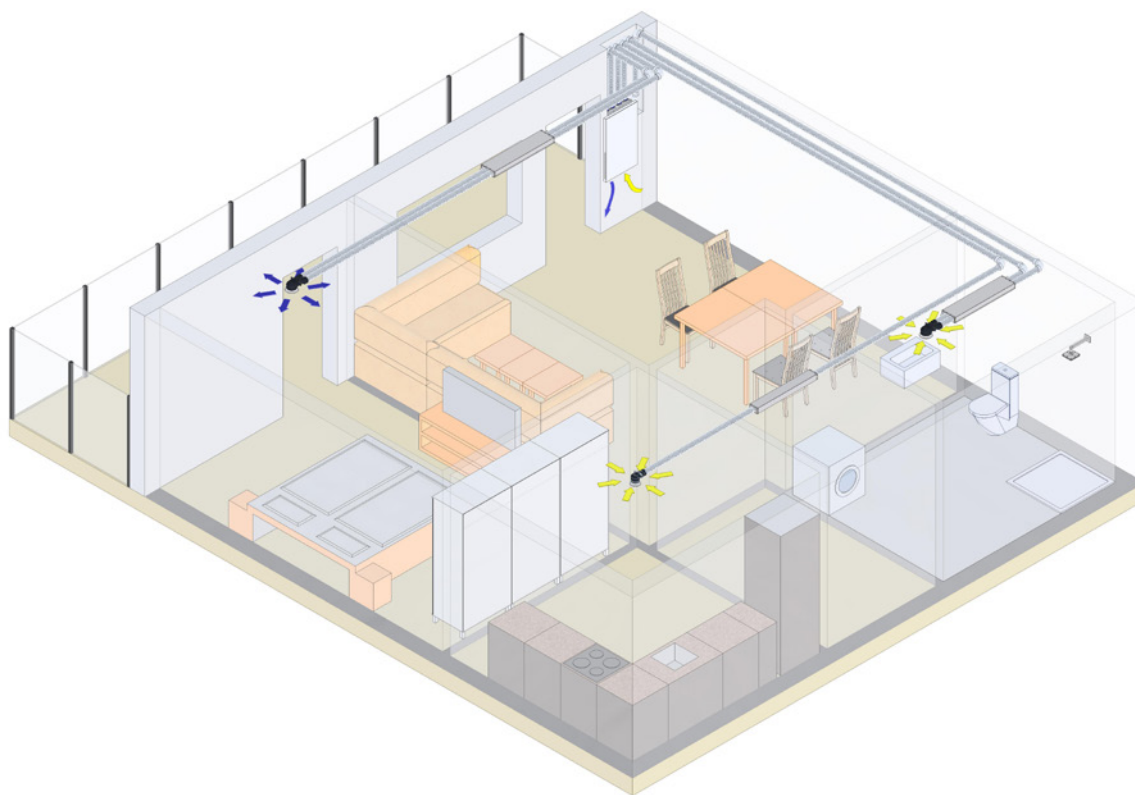

THE FOLLOWING ARTICLES ARE COMBINED FOR MULTI-ROOM APPLICATIONS AS A STANDARD

The flush-mounted housing (3), the EPS compensating insulation (4) and the EPP wall duct element (5) are already required in the shell construction phase. The remaining articles are installed at a later time in the completion phase. The connection of individual or several rooms to the ventilation unit is carried out using the KomFlex[®] air duct system. For multi-room applications we recommend the installation of flat sound absorbers.

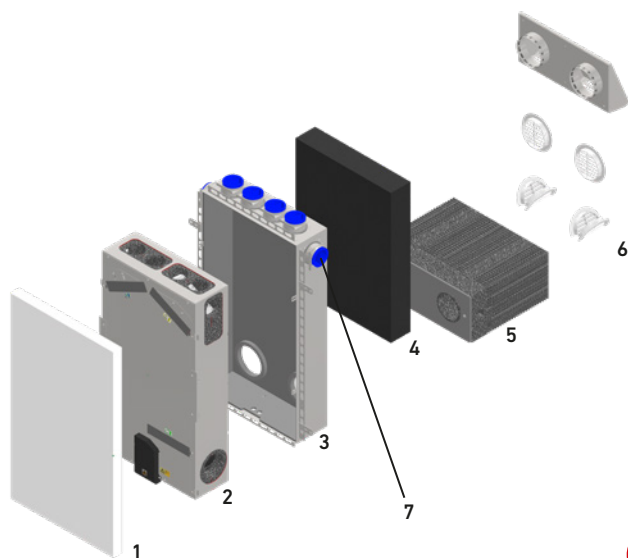

Item	Item number
1 Designfront, RAL9003, andere Ausführungen und Farben – siehe Seite 25	08LG100UPAPDF1A
2 Compact ventilation unit LG100 without housing	
a without pre-heater battery	08LG100UPF
b without pre-heater battery, GLA*	08LG100UPFGLA
c with pre-heater battery	08LG100UPFV
d with pre-heater battery, GLA*	08LG100UPFVGLA
3 Flush-mounted housing, multi-room application	08LG100UPGMRA
4 EPS compensating insulation, 100 mm	08LG100UPAGD1A
5 EPP wall duct element	08LG100UPWD
6 Facade end	
a Outside wall element NW125, V2A	08AWESV2A125
b Outside wall element NW125, galvanized steel, RAL9003**	08AWES125
c Plastic grille NW 80 to 125, white, mountable from the outside	10TU125B
d Plastic grille NW 100 to 140, white, mountable from the inside	10DF140B
7 Extension connection for an additional KomFlex [®] air duct	08LG100UPESETA

* Basic ventilation always active, cannot be switched off (DIN18017-3)

** Other colours on request



FLUSH-MOUNTED HOUSING, MULTI-ROOM APPLICATION (3)

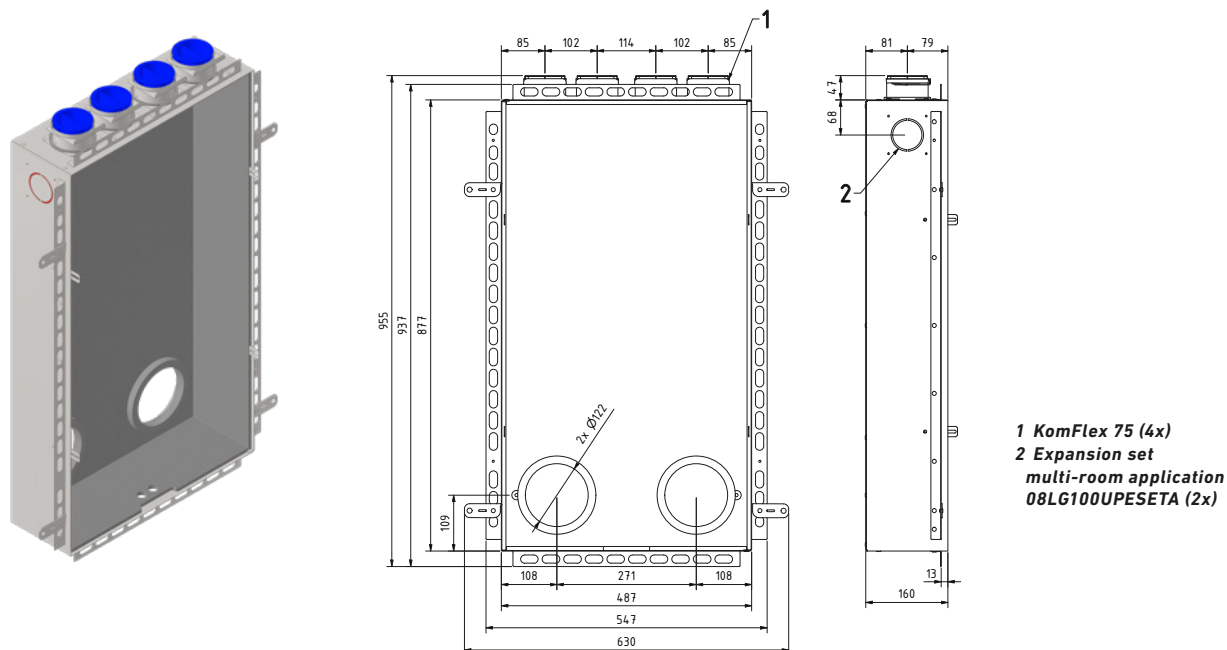

EPS COMPENSATING INSULATION (4)

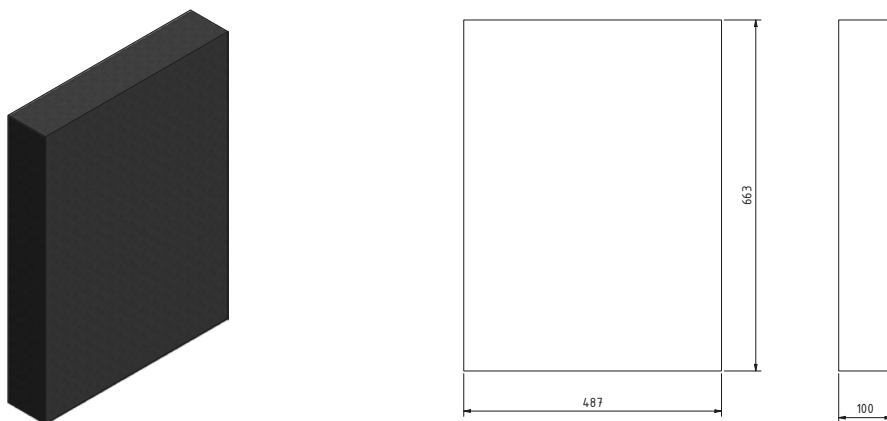

EPP WALL DUCT ELEMENT (5)

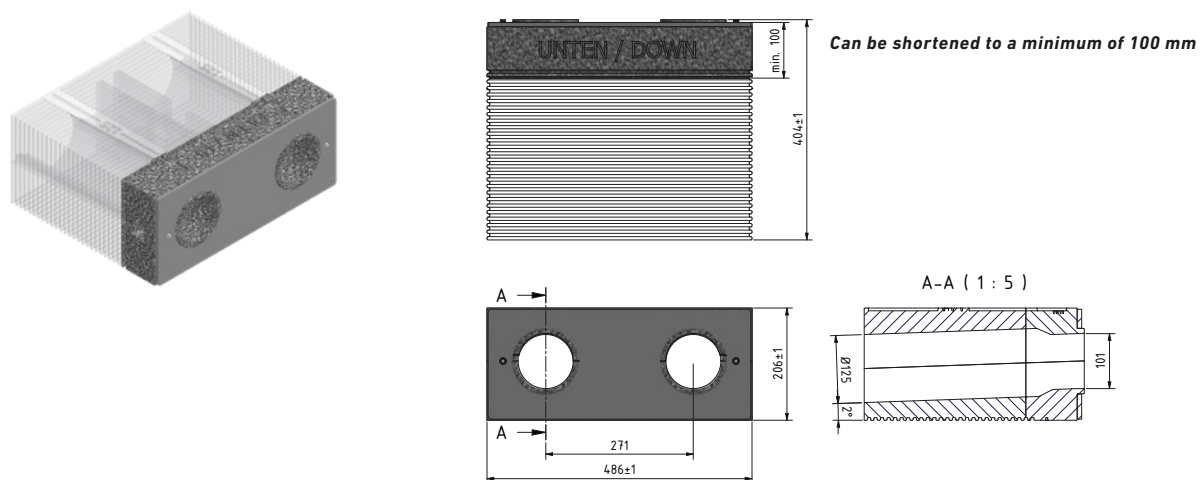

Flush-mounted fitting in concrete walls – single & multi-room application (recommended operating volume flow: 20 – 80 m³/h)

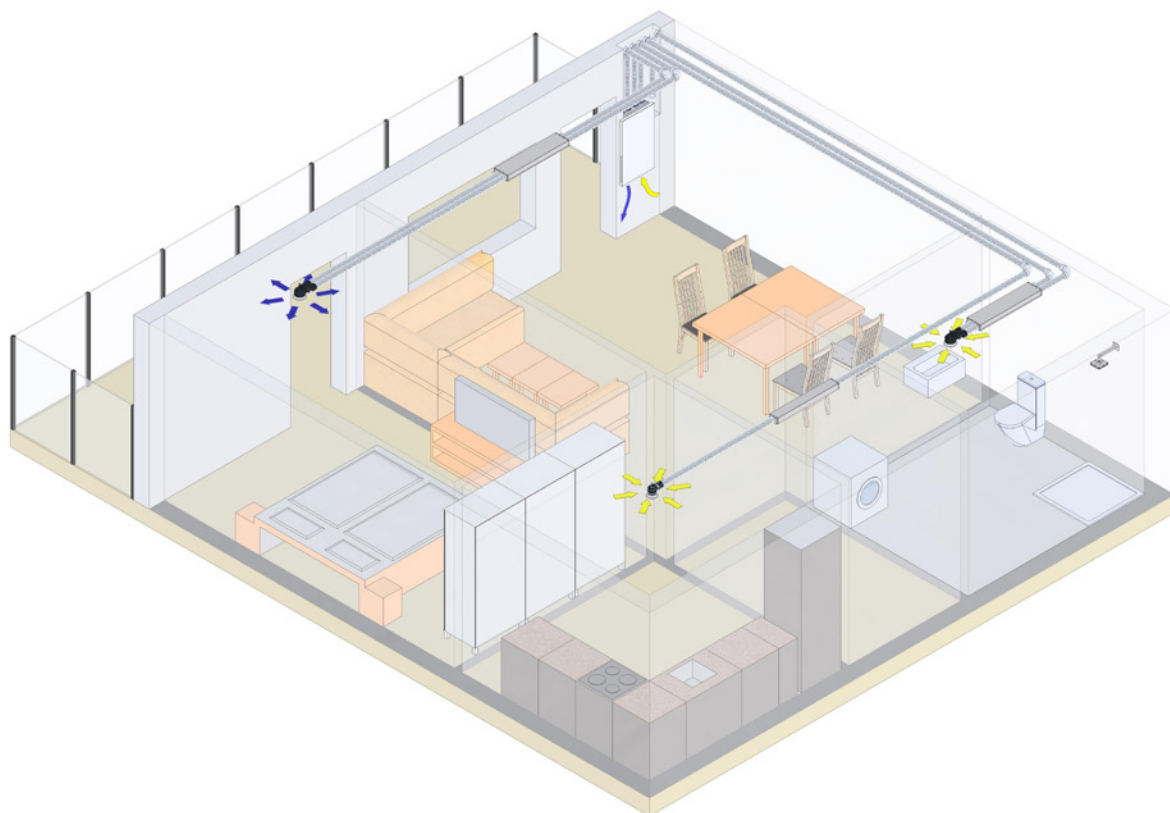

THE FOLLOWING ITEMS ARE TO BE COMBINED FOR USE IN CONCRETE WALLS AS STANDARD

The flush-mounted housing (3) and the EPP wall duct element (4) are required during the rough-in phase of installation. The other items can be subsequently fitted during the completion phase. The KomFlex® air duct system should be used to connect a single or multiple rooms to the air distribution device. If the system is to be used to supply multiple rooms, it is advisable to also install flat sound absorbers (see components).

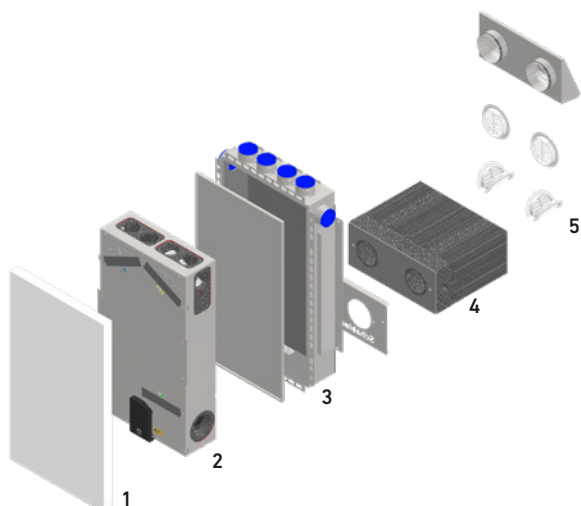

Item		Item number
1	Designfront, RAL9003, andere Ausführungen und Farben – siehe Seite 25	08LG100UPAPDF1A
2	Compact ventilation unit LG100 without housing	
a	without pre-heater battery	08LG100UPF
b	without pre-heater battery, GLA*	08LG100UPFGLA
c	with pre-heater battery	08LG100UPFV
d	with pre-heater battery, GLA*	08LG100UPFVGLA
3	Flush-mounted housing, multi-room application concrete	08LG100UPGMRAB
4	EPP wall duct element	08LG100UPWD
5	Facade end	
a	Outside wall element NW125, V2A	08AWESV2A125
b	Outside wall element NW125, galvanized steel, RAL9003**	08AWES125
c	Plastic grille NW 80 to 125, white, mountable from the outside	10TU125B
d	Plastic grille NW 100 to 140, white, mountable from the inside	10DF140B

* Basic ventilation always active, cannot be switched off (DIN18017-3)

** Other colours on request



FLUSH-MOUNTED HOUSING, MULTI-ROOM APPLICATION CONCRETE (3)

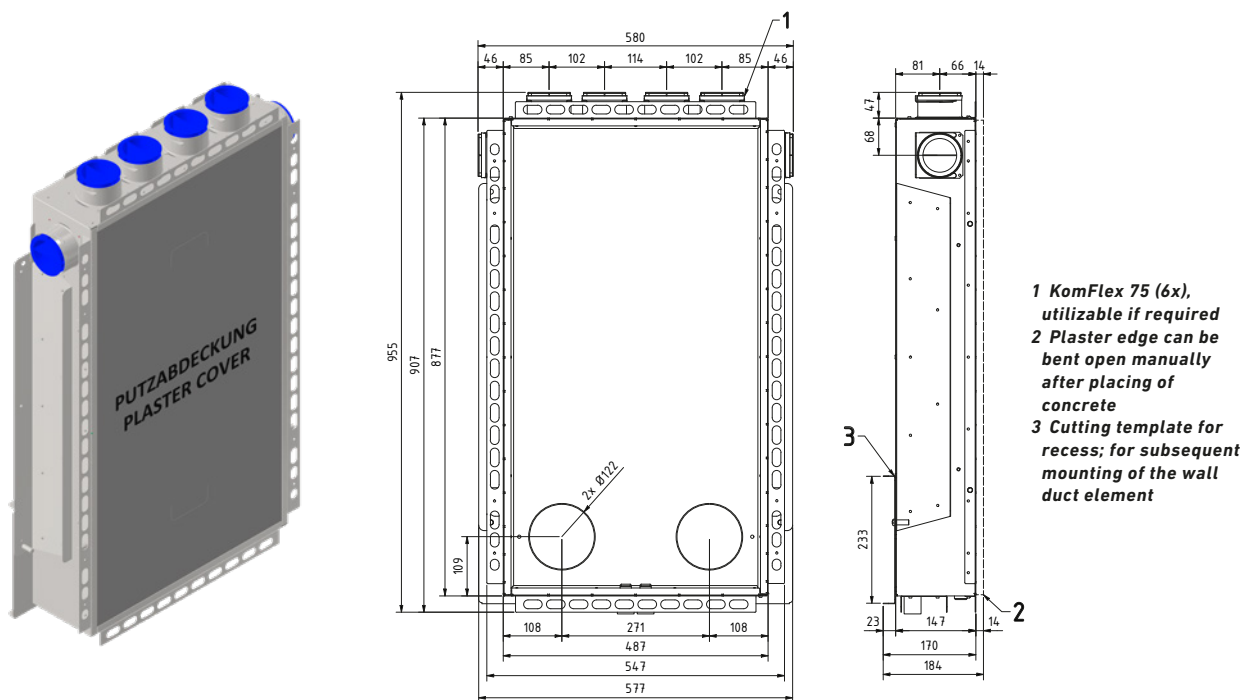

EPP WALL DUCT ELEMENT (4)

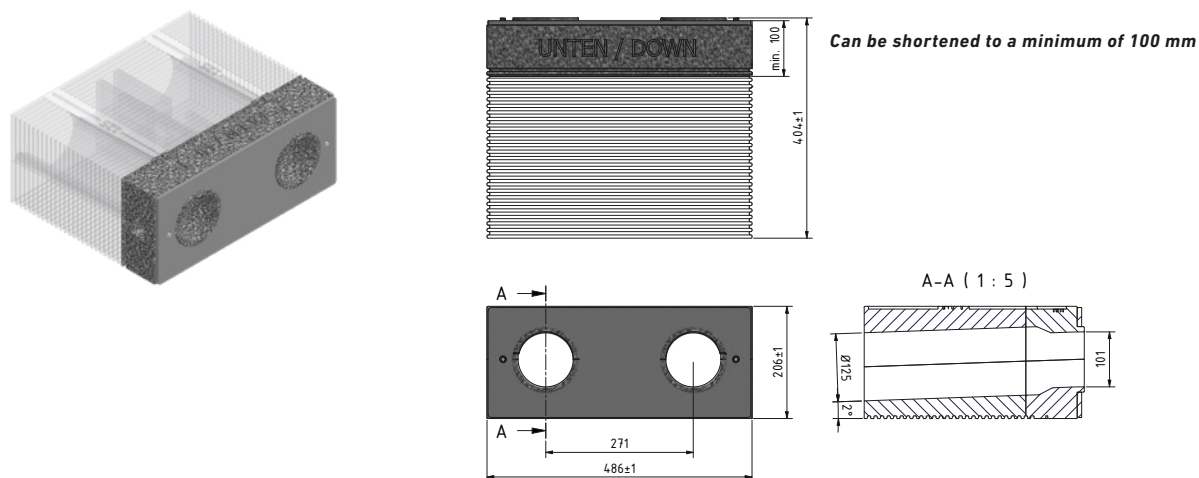

Flush-mounted fitting – wall-integrated – multi-room application (recommended operating volume flow: 20 – 80 m³/h)

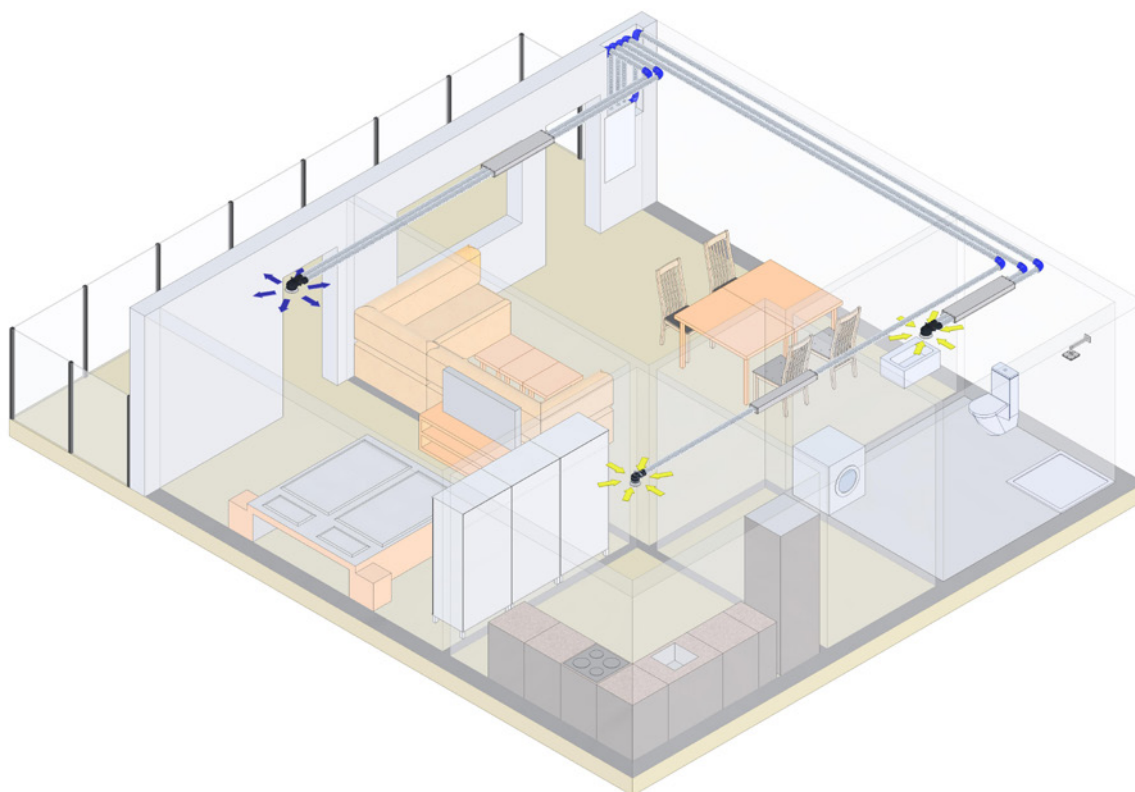

AS A STANDARD, THE FOLLOWING ARTICLES ARE COMBINED FOR WALL-INTEGRATED FITTING

The flush-mounted housing (3), the EPS compensating insulation (4) and the EPP wall duct element (5) are required during the rough-in phase of installation. The other items can be subsequently fitted during the completion phase. The KomFlex® air duct system should be used to connect a single or multiple rooms to the air distribution device. If the system is to be used to supply multiple rooms, it is advisable to also install flat sound absorbers (see components). The wall-integrated design offers the great advantage of an architecturally elegant solution, since the design front is flush with the wall. Please note: a greater construction depth is required.

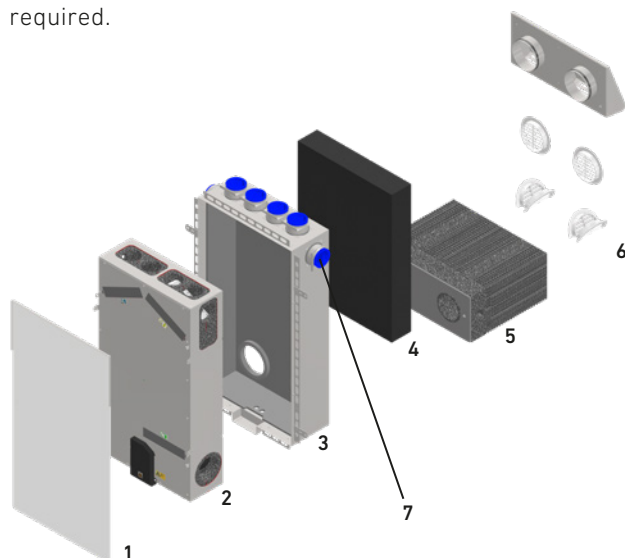

Item		Item number
1	Design front, aluminium, RAL9003	08LG100WIDF
2	Compact ventilation unit LG100 wall-integrated without housing	
a	without pre-heater battery	08LG100WIF
b	without pre-heater battery, GLA*	08LG100WIFGLA
c	with pre-heater battery	08LG100WIFV
d	with pre-heater battery, GLA*	08LG100WIFVGLA
3	Flush-mounted housing, wall-integrated, multi-room application	08LG100UPGMRAWI
4	EPS compensating insulation, 100 mm	08LG100UPAGD1A
5	EPP wall duct element	08LG100UPWD
6	Facade end	
a	Outside wall element NW125, V2A	08AWESV2A125
b	Outside wall element NW125, galvanized steel, RAL9003**	08AWES125
c	Plastic grille NW 80 to 125, white, mountable from the outside	10TU125B
d	Plastic grille NW 100 to 140, white, mountable from the inside	10DF140B
7	Extension connection for an additional KomFlex® air duct	08LG100UPESETA

* Basic ventilation always active, cannot be switched off (DIN18017-3)

** Other colours on request

FLUSH-MOUNTED HOUSING, WALL-INTEGRATED MULTI-ROOM APPLICATION (3)

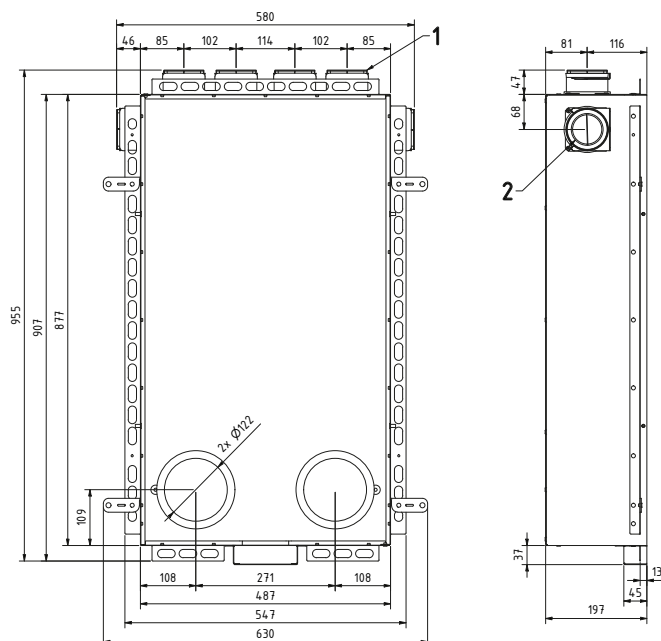
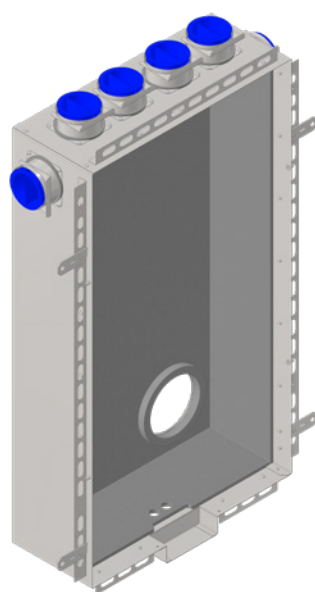

EPS COMPENSATING INSULATION (4)

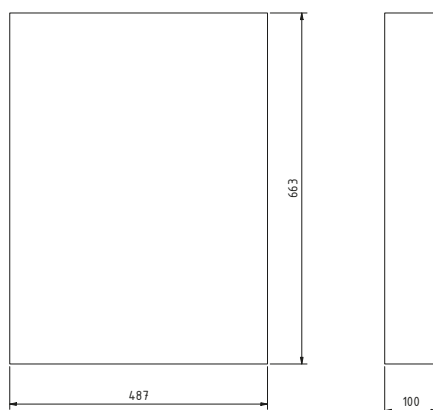
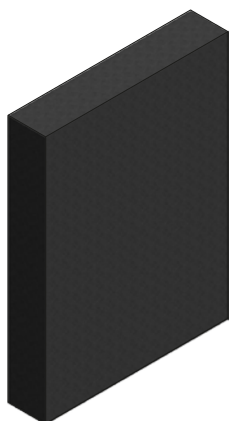

EPP WALL DUCT ELEMENT (5)

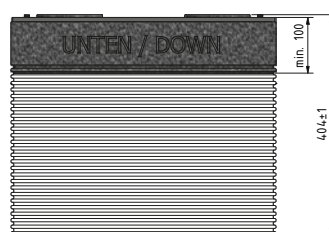
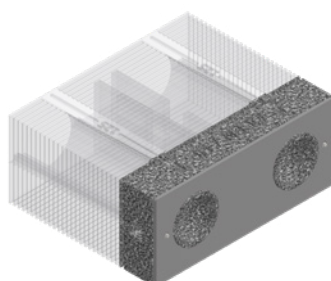

Can be shortened to a minimum of 100 mm

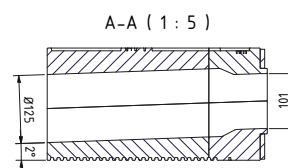
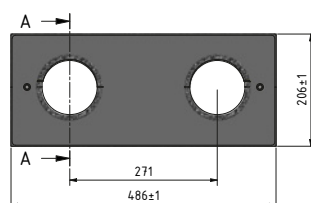

Flush-mounted fitting with a facing shell – multi-room application (recommended operating volume flow: 20 – 80 m³/h)

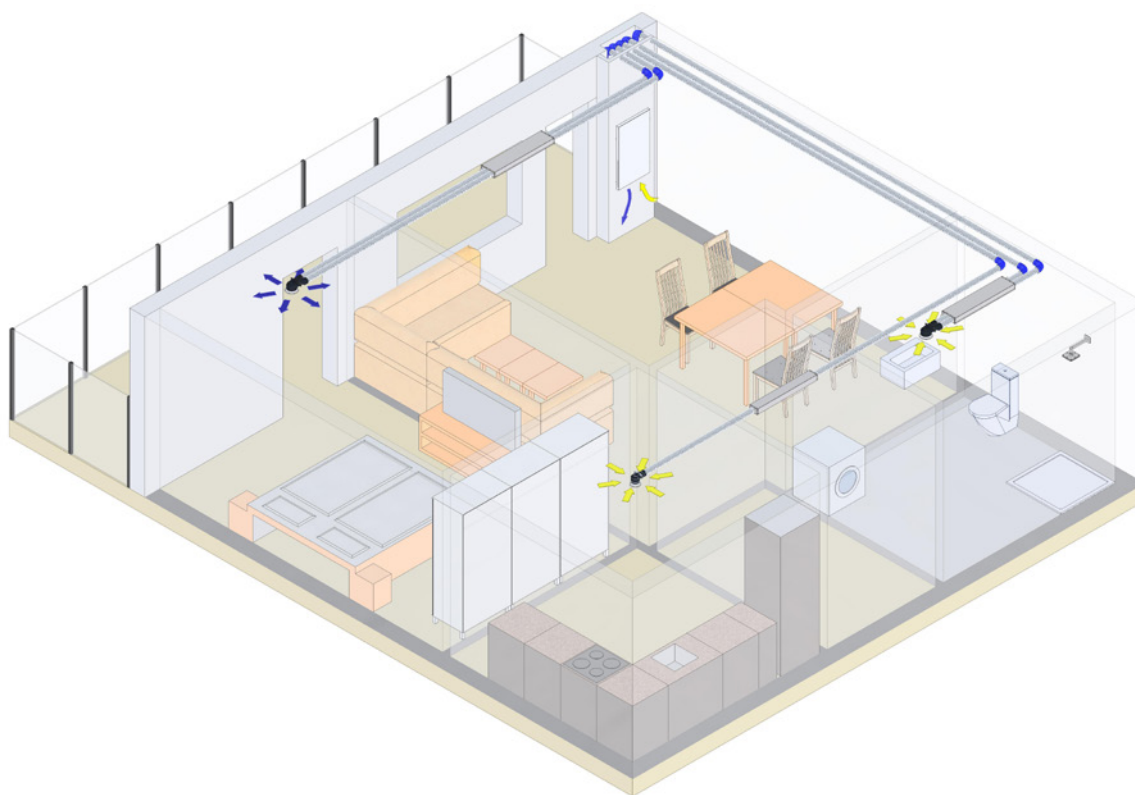

THE FOLLOWING ARTICLES ARE COMBINED WITH A FACING SHELL FOR MULTI-ROOM APPLICATIONS AS A STANDARD

The connection of individual or several rooms to the ventilation unit is implemented by means of the KomFlex® air duct system. For multi-room applications, we recommend the installation of flat acoustic dampers (see accessories).

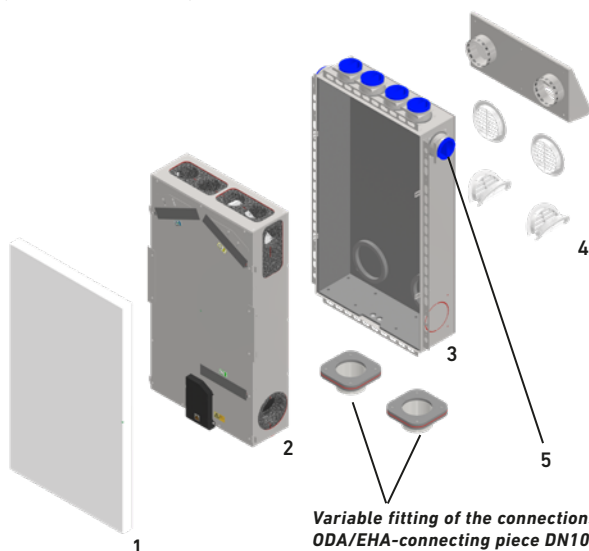

Variable fitting of the connections at the side or bottom.
ODA/EHA-connecting piece DN100 with or without lip seal.

Item	Item number
1 Design front, RAL 9003, other designs and colours – see page 25	08LG100UPAPDF1A
2 Compact ventilation unit LG100 without housing	
a without pre-heater battery	08LG100UPF
b without pre-heater battery, GLA*	08LG100UPFGLA
c with pre-heater battery	08LG100UPFV
d with pre-heater battery, GLA*	08LG100UPFVGLA
3 Flush-mounted housing, multi-room application	
a Connectors without lip seal	08LG100UPGMRAVS (standard)
b Connectors with lip seal	08LG100UPGMRAVSL (optional)
4 Facade end	
a Outside wall element NW100, V2A	08AWESV2A100
b Outside wall element NW100, galvanized steel, RAL9003**	08AWES100
c Plastic grille NW 80 to 125, white, mountable from the outside	10TU125B
d Plastic grille NW 100 to 140, white, mountable from the inside	10DF140B
5 Extension connection for an additional KomFlex® air duct	08LG100UPESETA

* Basic ventilation always active, cannot be switched off (DIN18017-3)

** Other colours on request



FLUSH-MOUNTED HOUSING, MULTI-ROOM APPLICATION WITH FACING SHELL (3)

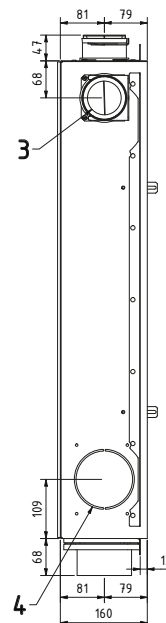
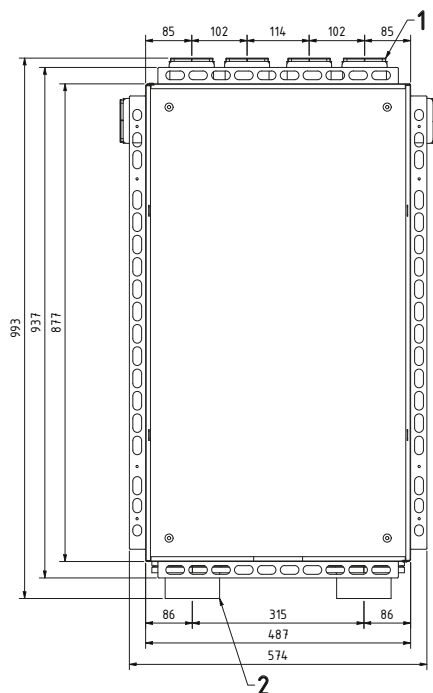
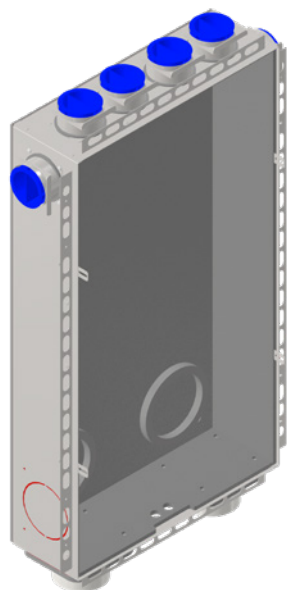

- 1 KomFlex 75 (4x)
- 2 ODA/EHA connecting piece DN 100 NP (2x, changeable to the side)
- 3 Expansion set multi-room application 08LG100UPESETA (2x)
- 4 Preparation for ODA/EHA connecting piece (2x)



Flush-mounted fitting – window reveal connection (single-room and multi-room connection)

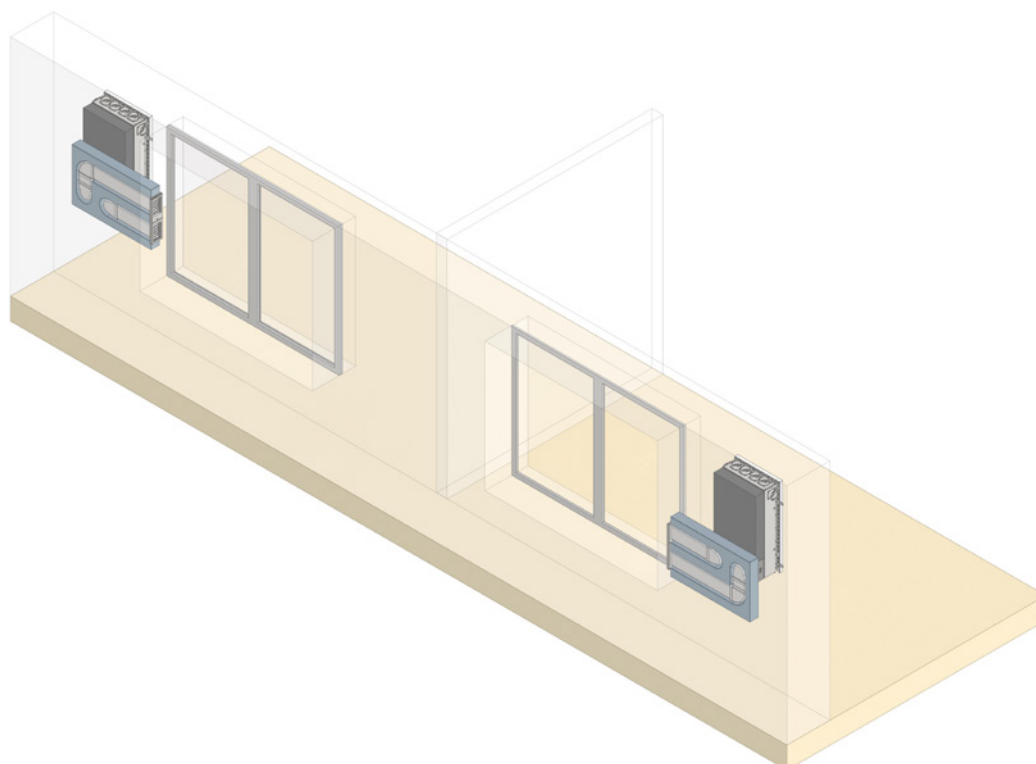

THE FOLLOWING ARTICLES ARE COMBINED FOR THE REVEAL CONNECTION AS A STANDARD

Item	Item number
1 Exterior wall element window reveal, RAL 9003*	08LG100FLAWE1A
2 Window reveal connection set	08LG100FLASETA
3 Window reveal insulation panel	08LG100FLDPA
4 EPP wall duct element	08LG100UPWD
5 EPS compensating insulation, 100 mm	08LG100UPAGD1A

* Other designs and colours on request

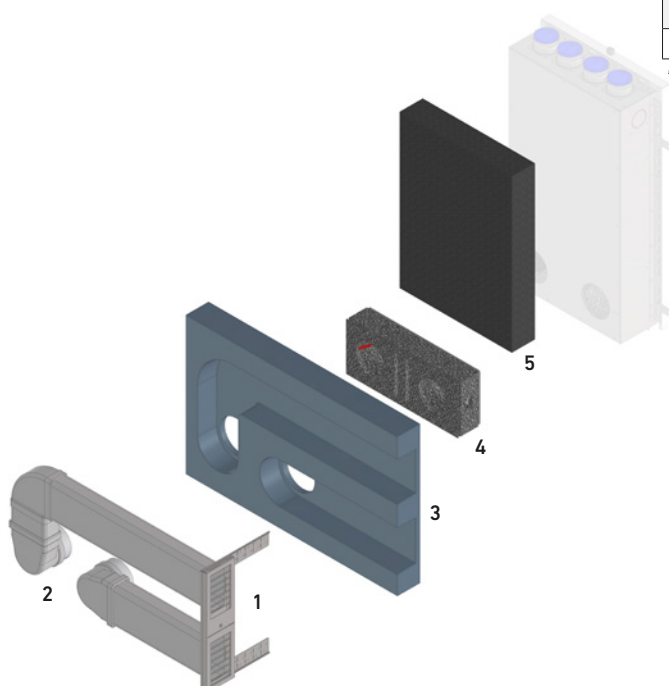

EXTERIOR WALL ELEMENT WINDOW REVEAL (1) & WINDOW REVEAL CONNECTION SET (2)

Item	Item number
1 1 pc. Exterior wall element window reveal, RAL 9003*	08LG100FLAWE1A

* Other designs and colours on request

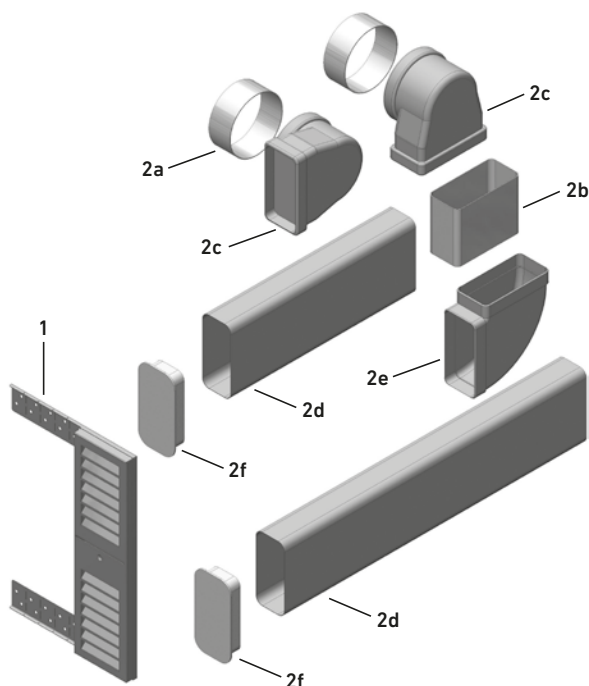

Item	Item number
2 LG100UP/AP connection set for window reveal	08LG100FLASETA
a 2 pcs. Pre-cut parts round pipe \varnothing 125 mm	40LG0300064A
b 1 pc. Pre-cut part flat duct, W x H = 150 x 70 mm	40LG0300065A
c 2 pcs. Junctions square / round	08UERV12515070
d 2 pcs. Flat ducts 1 m made from plastic	08K150701000
e 1 pc. Bend 90° flat	08B9015070
f 2 pcs. Endcovers for ducts	08EP15070

Shorten here if necessary Drain opening

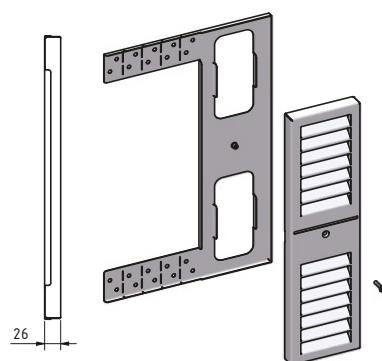
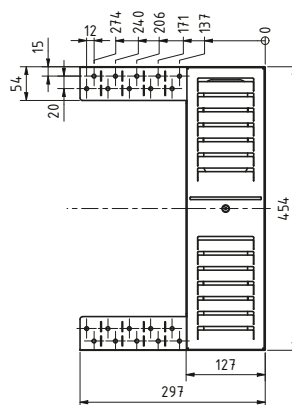
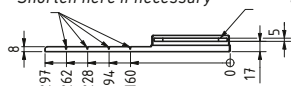

WINDOW REVEAL INSULATION PANEL (3)

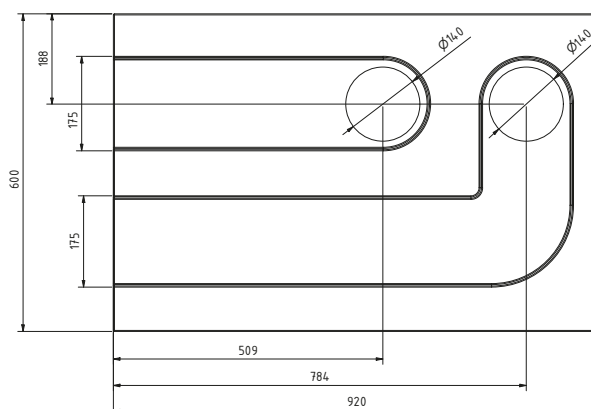
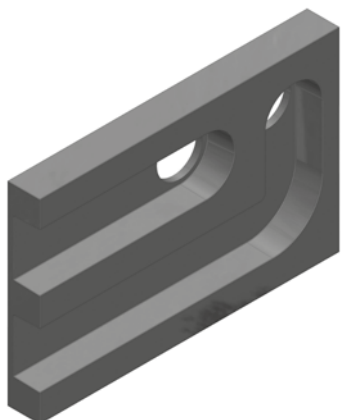

EPP WALL DUCT ELEMENT (4)

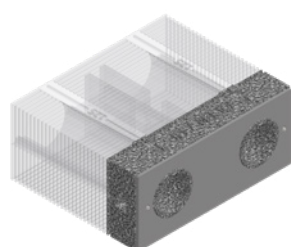

Can be shortened to a minimum of 100 mm

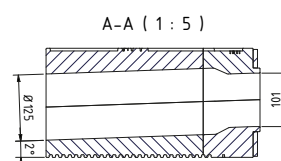
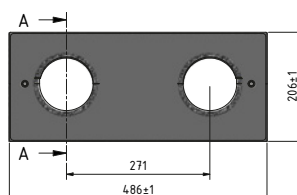
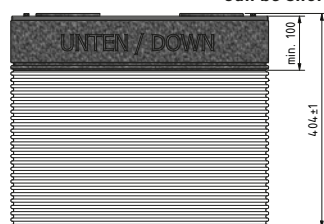

Surface-mounted installation – single-room application **(recommended operating volume flow: 20 – 60 m³/h)**

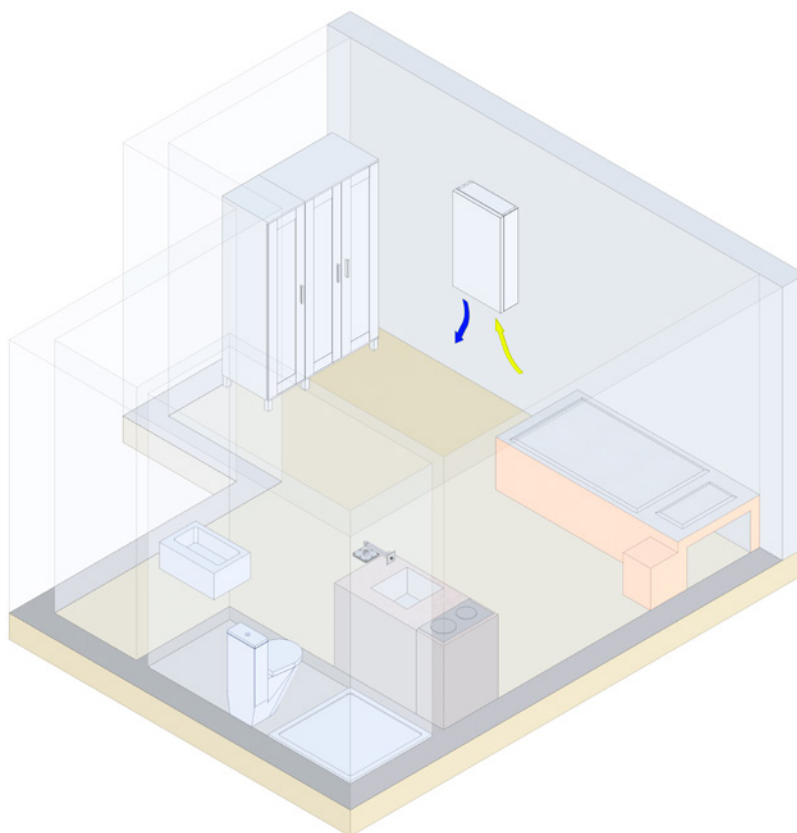

FOR SINGLE-ROOM APPLICATIONS IN THE SURFACE-MOUNTED HOUSING, THE FOLLOWING DESIGN VARIANTS ARE PROVIDED

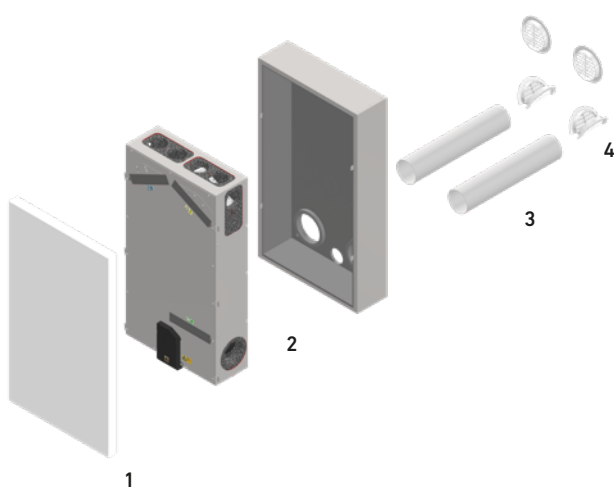

Item		Item number
1	Design front, RAL 9003, other designs and colours – see page 25	08LG100UPAPDF1A
2	Compact ventilation unit LG100 surface-mounted unit with housing	
a	without pre-heater battery	08LG100APF
b	without pre-heater battery, GLA*	08LG100APFGLA
c	with pre-heater battery	08LG100APFV
d	with pre-heater battery, GLA*	08LG100APFVGLA
3	Round tube plastics, NW 125mm, L=1000mm	08R1251000
4	Facade end	
a	Plastic grille NW 80 to 125, white, mountable from the outside	10TU125B
b	Plastic grille NW 100 to 140, white, mountable from the inside	10DF140B

* Basic ventilation always active, cannot be switched off (DIN18017-3)

** Other colours on request



ASURFACE-MOUNTED UNIT WITH HOUSING FOR SINGLE-ROOM APPLICATIONS (1, 2)

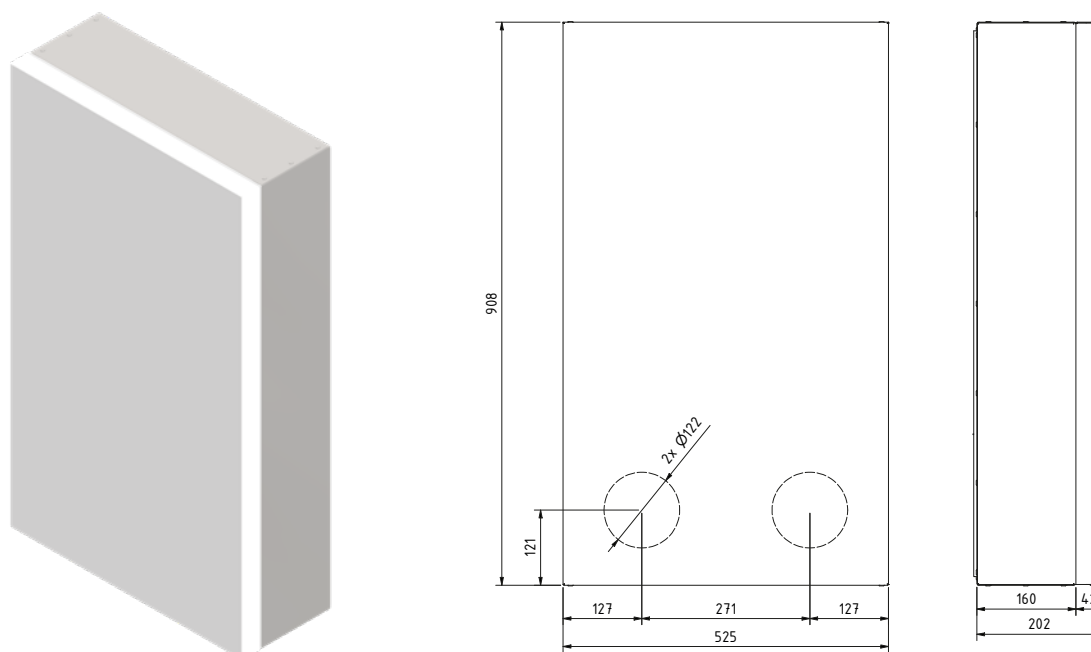

Ceiling mounting (recommended operating volume flow: 20 – 80 m³/h)

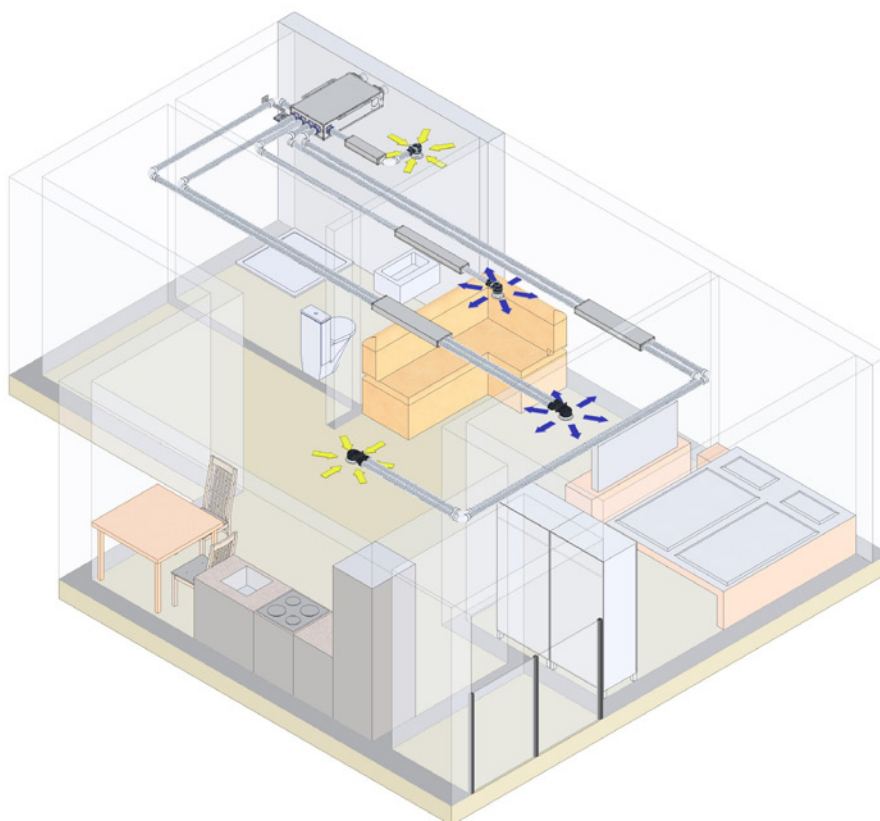

FOR MULTI-ROOM APPLICATION IN THE SUSPENDED CEILING, THE FOLLOWING DESIGN VARIANTS ARE PROVIDED

The rooms are connected to the ventilation unit using the KomFlex® air duct system. For multi-room applications we recommend installing flat sound absorbers.

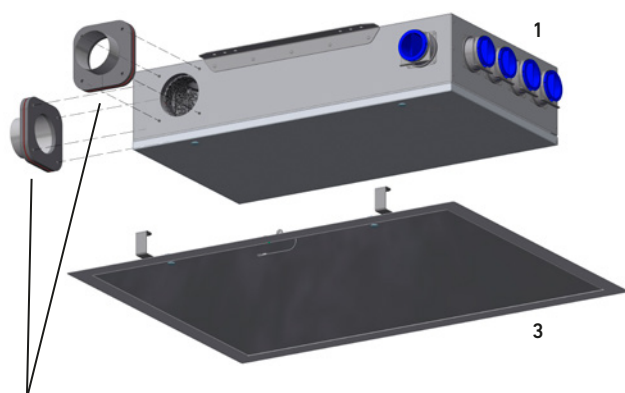

Variable installation of the connection at the side or rear. ODA/EHA connecting piece DN100 with or without lip seal.

Item	Item number
1 Compact ventilation unit LG100DE ceiling unit	
a without pre-heater battery, connecting piece without lip seal	08LG100DEF
b without pre-heater battery, connecting piece without lip seal, GLA*	08LG100DEFGLA
c without pre-heater battery, connecting piece with lip seal	08LG100DEFL
d without pre-heater battery, connecting piece with lip seal, GLA*	08LG100DEFLGLA
e with pre-heater battery, connecting piece without lip seal	08LG100DEFV
f with pre-heater battery, connecting piece without lip seal, GLA*	08LG100DEFVGLA
g with pre-heater battery, connecting piece with lip seal	08LG100DEFVL
h with pre-heater battery, connecting piece with lip seal, GLA*	08LG100DEFVLGLA
2 Operating control unit MINI LG100	08MINI100
3 Inspection cover, RAL 9003**	08LG100150REVDE

* Basic ventilation always active, cannot be switched off (DIN18017-3)

** Other colours on request



CEILING UNIT FOR MULTI-ROOM APPLICATION (1)

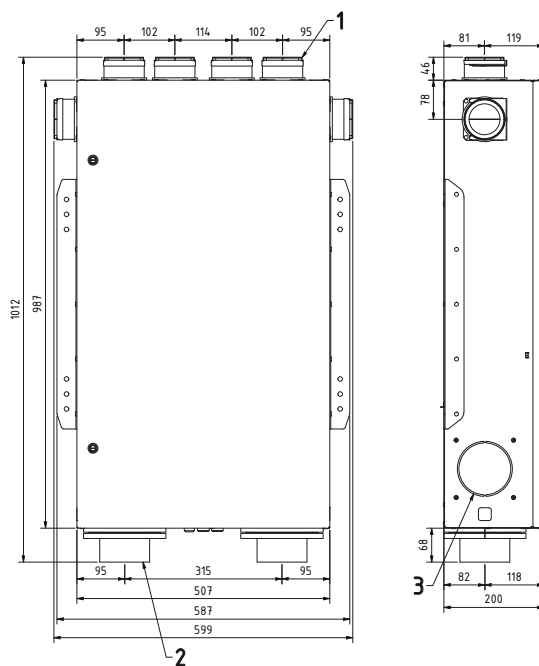
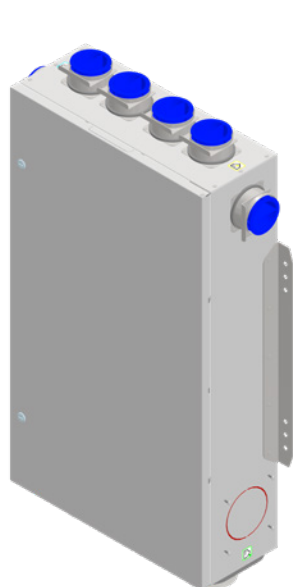

- 1 KomFlex 75 (6x)
- 2 ODA/EHA connecting piece DN 100 NP (2x, changeable to the side)
- 3 Preparation for ODA/EHA connecting piece (2x)

INSPECTION COVER (3)

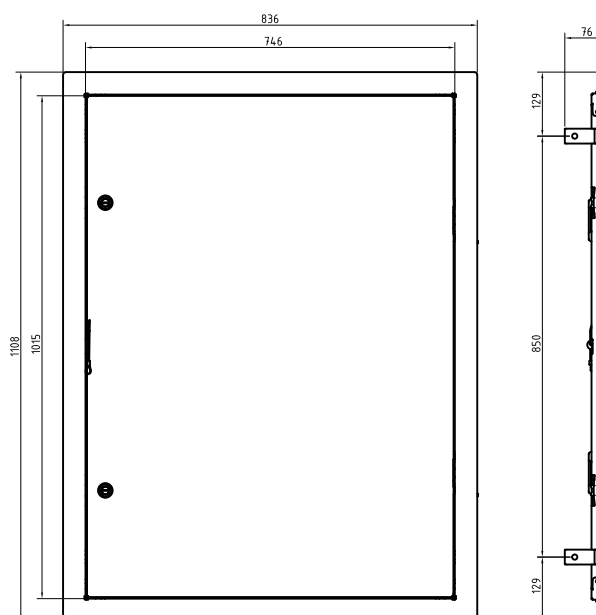
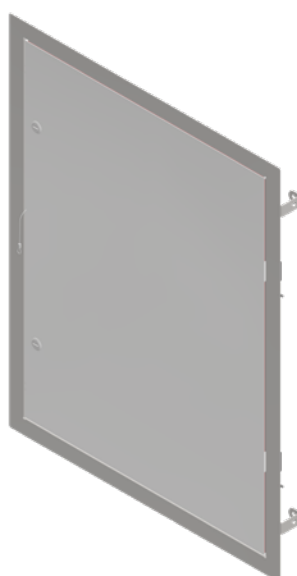



**Design acoustic insulation valve
SDV for supply air**

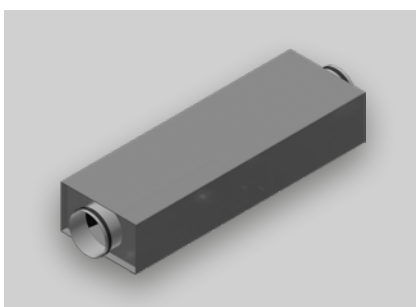

**Deflection sound absorber USDF
for outdoor air and exhaust air**

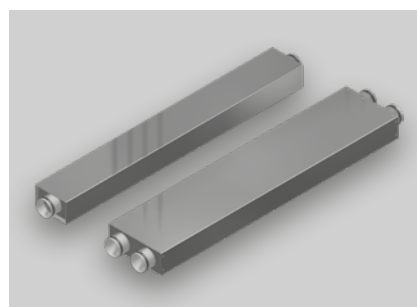

**Flat acoustic damper PFSDW
for supply air and extract air**

Accessories

SPARE FILTER

Will ensure perfect hygiene and air quality given regular replacement, also proper functionality and efficient operation of the equipment.

Item	Item number
Filter ODA ISO Coarse 70% (outdoor air – pre-filter)	40LG0500006A
Filter SUP ISO ePM1 55% (supply air – fine filter)	40LG0500007A
Filter ETA ISO Coarse 70% (extract air)	40LG0500006A

DESIGN ACOUSTIC INSULATION VALVE SDV

Supply valve for wall mounting with optimised acoustic properties. Connecting links with glass silk surface.

Colour: white (RAL 9003). Other colours on request.

Material: sheet steel, galvanised

Dimensions: W x H x D = 337 x 175 x 90 mm

Item	Item number
Design acoustic insulation valve SDV 100, air connection: ø 100 mm (SAFE system)	10SDV10003
Design acoustic insulation valve SDV 125, air connection: ø 125 mm (SAFE system)	10SDV12503
Design acoustic insulation valve SDV 125 without ILU, air connection ø 125 mm without spigot, Opening sealed with 4 mm insulation on the back	10SDV1250ILU03

DEFLECTION SOUND ABSORBER USDF

- Square sound absorber with connecting links optimised in terms of fluid mechanics and acoustics in flat design.
- Housing made of galvanized sheet steel
- Connecting links with high-strength, wear-resistant and moisture-repelling surface made from glass silk with absorption and response elements for optimum sound attenuation
- Connecting piece with double lip seal for plug-in assembly

Item	Item number
Flat deflection sound absorber without inspection cover, air connection: ø 100 mm (SAFE system), dimensions: W x H x L = 202 x 115 x 600 mm	08USDF100600

FLAT ACOUSTIC DAMPER PFSDW

Flat deflection sound absorber with duct connection and an integrated perforated plate including mineral wool cased with glass silk. The outer housing is made of galvanised sheet steel. Connectors with lip seal for plug-in assembly. (SAFE system) or with strain relief (08TPEDR6275 seal must be ordered).

Plug-in installation with SAFE system	Item number
Flat acoustic damper PFSDW, air connection: 1 x Ø 63 mm for KomFlex® 75, dimensions: W x H x L = 130 x 80 x 1000 mm	08PFSDW631000
Flat acoustic damper PFSDW, air connection: 2 x Ø 63 mm for KomFlex® 75, dimensions: W x H x L = 220 x 80 x 1000 mm	08PFSDW6310002
Flat acoustic damper PFSDW, air connection: 1 x Ø 63 mm for KomFlex® 75, dimensions: W x H x L = 130 x 80 x 500 mm	08PFSDW63500
Flat acoustic damper PFSDW, air connection: 2 x Ø 63 mm for KomFlex® 75, dimensions: W x H x L = 220 x 80 x 500 mm	08PFSDW635002
Flat acoustic damper PFSDW, air connection: 1 x Ø 63 mm for KomFlex® 75, dimensions: W x H x L = 130 x 80 x 750 mm	08PFSDW63750
Flat acoustic damper PFSDW, air connection: 2 x Ø 63 mm for KomFlex® 75, dimensions: W x H x L = 220 x 80 x 750 mm	08PFSDW637502

Plug-in installation with strain relief	Item number
Flat acoustic damper PFSDW, air connection: 1 x Ø 75 mm for KomFlex® 75, dimensions: B x H x L = 130 x 90 x 1000 mm	08PFSDW1751000ILNH
Flat acoustic damper PFSDW, air connection: 2 x Ø 75 mm for KomFlex® 75, dimensions: B x H x L = 220 x 90 x 1000 mm	08PFSDW2751000ILNH
Flat acoustic damper PFSDW, air connection: 1 x Ø 75 mm for KomFlex® 75, dimensions: B x H x L = 130 x 90 x 500 mm	08PFSDW175500ILNH
Flat acoustic damper PFSDW, air connection: 2 x Ø 75 mm for KomFlex® 75, dimensions: B x H x L = 220 x 90 x 500 mm	08PFSDW275500ILNH



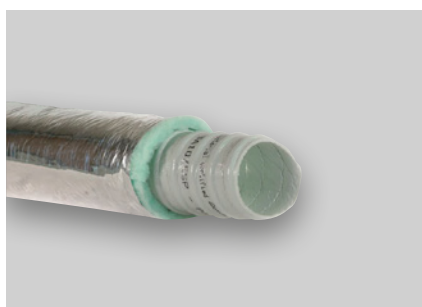

Plastic hose for outdoor air and exhaust air

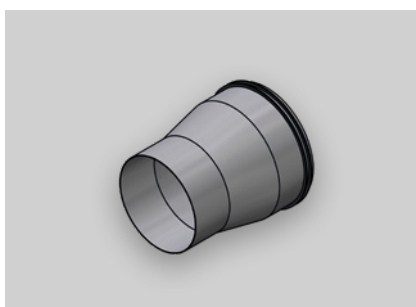

Reduction Safe RCFU



Modbus/KNX Gateway

PLASTIC HOSE INSULATED POH

Additivated polyolefin resin foil with antibacterial, mould-inhibiting and antiviral material protection. Heat-insulating coating of meshed and closed-cell PE foam. When using the plastic hose, the connecting pieces without lip seal will be more suitable for the installation.

Insulation: 25mm polyester fibre (16kg/m³)

Operating temperature: -20°C to +90°C (115°C peak value)

Max. operating pressure: 2000 Pa

Max. air velocity: 20m/s

5 running meters (RMT) = 1 piece (pc)

Item	Item number
Plastic hose insulated PHO, air connection: ø 100 mm (sleeve size)	11POH10225

REDUCTION SAFE RCFU

Pipe connection: Ø 125 mm (SAFE system)

NPS reduction: Ø 100 mm (sleeve size)

Total length: 145 mm

Without corrugations

Item	Item number
Reduction Safe RCFU	11RCFU125100SV

BEND EPP-B

EPP bend of expanded polypropylene for quick mounting.

System pressure: max. 630 Pa

Tightness class: C

Thermal conductivity: $\lambda = 0.035$ W/mK

Item	Item number
øD = 125 mm, angle: 90°, wall thickness: 15 mm, with sleeve, friction coefficient: $\zeta = 0.21$	08EPPB1259015

SLEEVE EPP-MF

EPP sleeve of expanded polypropylene for the connection of pipes and fittings.

System pressure: max. 630 Pa

Tightness class: C

Thermal conductivity: $\lambda = 0.035$ W/mK

Friction coefficient: $\zeta = 0,16$

Item	Item number
øD = 125 mm, wall thickness: 15 mm, with sleeve	08EPPMF12515

PIPE EPP-R

EPP pipe of expanded polypropylene for quick mounting.

System pressure: max. 630 Pa

Tightness class: C

Thermal conductivity: $\lambda = 0.035$ W/mK

Item	Item number
øD = 125 mm, length: 1000 mm, wall thickness: 15 mm, with sleeve, friction coefficient: $\zeta = 0.18$	08EPPR125151

MODBUS/KNX GATEWAY

The Modbus/KNX gateway allows for the connection of the ventilation unit to a KNX bus system. In this process, the gateway serves as a connective link between the two bus systems. Note that the master is always on the Modbus. On the KNX side, however, it responds like a common KNX TP-1 unit. This makes it possible to centrally control and monitor the ventilation unit by a KNX system. In order to facilitate the configuration, ETS template projects are provided for download for a variety of ventilation units.

Dimensions: L x W x D = 18 x 100 x 60 mm

Mounting: top hat rail or wall

Permissible ambient temperature: -5 to 45 °C

Permissible humidity: 5 – 93 % non-condensing

Protection class: IP20

Voltage: 12...24V DC

Interfaces: Ethernet, EIA-485, KNX-TP1

Item	Item number
Modbus/KNX Gateway	08KNXGAB



Technical data

Equipment type	LG 100 UP – flush-mounted		LG 100 AP – surface-mounted	LG 100 DE – ceiling-mounted
Application	Single-room application	Multi-room application	Single-room application	Multi-room application
Item no. ventilation unit	08LG100UPF	08LG100UPF	08LG100APF	08LG100DEF(L)
Item no. ventilation unit with pre-heater battery	08LG100UPFV	08LG100UPFV	08LG100APFV	08LG100DEF(L)V
Item no. ventilation unit, GLA function / basic ventilation active	08LG100UPFGLA	08LG100UPFGLA	08LG100APFGLA	08LG100DEF(L)GLA
Item no. ventilation unit with pre-heater battery, GLA function / basic ventilation active	08LG100UPFVGLA	08LG100UPFVGLA	08LG100APFVGLA	08LG100DEFV(L)GLA
Item no. housing	08LG100UPGERA	08LG100UPGMRA	Included in the unit	Included in the unit
Item no. design front, RAL 9003 (for other designs and colours see page 25)	08LG100UPAPDF1A	08LG100UPAPDF1A	08LG100UPAPDF1A	im Gerät enthalten



Device data				
Ventilation stages	1 – 2 – 3 – automatic			
Level 1 – basic ventilation (not selectable for the GLA version / basic ventilation active)	20	20	20	20
Level 2 – normal ventilation	42	56	42	56
Level 3 – boost ventilation	60	80	60	80
Automatic (demand-based)	20 – 60	20 – 80	20 – 60	20 – 80

Properties	
Volume flow constant function	yes
Humidity control	yes
Air quality control (VOC, eCO ₂)	yes
Mechanical cover flap in the outdoor air and exhaust air pipe	yes

Energy efficiency class	A	A	A	A
-------------------------	---	---	---	---

Characteristic values in compliance with EN13141-8:2014 ¹⁾				
Temperature ratio $\eta_{e,su}$	83,6 %	80,4 %	83,6 %	–
Humidity ratio supply air $\eta_{x,su}$	69,1 %	64,3 %	69,1 %	–
Specific input power SEL	0,28 Wh/m ³	0,32 Wh/m ³	0,28 Wh/m ³	–

Characteristic values in compliance with EN13141-7:2011 ¹⁾				
Temperature ratio $\eta_{e,su}$	–	–	–	80,4%
Humidity ratio supply air $\eta_{x,su}$	–	–	–	64,3%
Specific input power SEL	–	–	–	0,32 Wh/m ³

Classification of air filters in accordance with EN ISO 16890	
 ODA filter (outdoor air – pre-filter)	ISO Coarse 70% (Item No.: 40LG0500006A)
 SUP filter (supply air – fine filter)	ISO ePM1 55% (Item No.: 40LG0500007A)
 ETA filter (extract air)	ISO Coarse 70% (Item No.: 40LG0500006A)

Operating conditions	
Permissible operating temperature (outdoor air) with/without preheating battery	–15 °C / –5 °C
Condensate separation	not required ²⁾

¹⁾ At 70 % of the max. volume flow; corresponds to ventilation level 2

²⁾ When used as intended as living space ventilation unit, no condensate will form



Equipment type	LG 100 UP – flush-mounted	LG 100 AP – surface-mounted	LG 100 DE – ceiling-mounted
----------------	------------------------------	--------------------------------	--------------------------------

Electrical system			
Electrical connection	230 V / 1 ~ / 50 Hz / 13 A		
Power consumption of ventilation unit	8 – 40 watts		
Power consumption of preheating battery	280 watts		

Materials and components		
Inner part	EPP and galvanised steel sheets	
Design front	Steel sheet, galvanised and powder-coated	–
Heat exchanger	Enthalpy counterflow heat exchanger with a polymer membrane	
Fans	EC radial fans	

Air connections			
Outdoor air / exhaust air	100 mm		
Multi-room connection supply air	–	3 x KOMFLEX 75	–
Multi-room connection extract air	–	3 x KOMFLEX 75	–

Acoustic insulation			
Standardised sound level difference $D_{n,e,w}$ Standby	57 dB(A)	55 dB(A)	n. a.
Standardised sound level difference $D_{n,e,w}$ operation	55 dB(A)	55 dB(A)	n. a.

Dimensions and weight			
Unit dimensions W x H x D (without connections)	547 x 937 x 202 mm	525 x 908 x 200 mm	587 x 937 x 203 mm
Weight	25 kg	25 kg	25 kg
Design front	525 x 908 x 43 mm	525 x 908 x 43 mm	–
Weight	5 kg	5 kg	–

Certifications			
TÜV-tested	yes		
Building inspection approval (DIBt (German Institute for Structural Engineering))	Z-51.3-489	Z-51.3-490	



Acoustic data

Single-room application LG 100 UP and LG 100 AP		Volume flow m ³ /h		
		25	42	60
Housing	Sound pressure level at a distance of 1 m L _{PA,1m} dB(A)	< 20	22	29
	Sound power level L _{WA} dB(A)	29	35	43
Outdoor air / exhaust air	Sound power level L _{WA} dB(A) weather protection	41	53	62
	Sound power level L _{WA} dB(A) reveal	39	50	58

Multi-room application LG 100 UP Distribution: Design front approx. 1/3, KOMFLEX pipes approx. 2/3		Volume flow m ³ /h			
		42	56	70	80
Housing	Sound pressure level at a distance of 1 m L _{PA,1m} dB(A)	< 20	22	27	29
	Sound power level L _{WA} dB(A)	32	35	40	42
Outdoor air / exhaust air	Sound power level L _{WA} dB(A) weather protection	48	55	57	64
	Sound power level L _{WA} dB(A) reveal	45	52	54	60

Ceiling unit LG 100 DE		Volume flow m ³ /h			
		42	56	70	80
Housing	sound power level L _{WA} dB(A)	31	37	41	45
Outdoor air connection	sound power level L _{WA} dB(A)	50	55	58	61
Exhaust air connection	sound power level L _{WA} dB(A)	51	56	63	67
Supply air connection	sound power level L _{WA} dB(A)	39	44	48	51
Extract air connection	sound power level L _{WA} dB(A)	39	44	50	53



Design front variants

The standard front of the LG 100 is classic white in RAL 9003. Architecturally appealing solutions can be implemented by means of different design fronts for the flush-mounted & surface solution. By their individual design possibilities, the variants allow for integration into modern architecture.

All fronts can be used as magnetic boards. Additionally, the glass variants can also be written on using whiteboard pens.

	Item	Item number
1	Design front, galvanized sheet steel in RAL 9003 with matt coating*	08LG100UPAPDF1A
2	Design front, prisms film*	08LG100UPAPDF2A
3	Design front, line-art film*	08LG100UPAPDF3A
4	Design front, glass white*	08LG100UPAPDF4A
5	Design front, glass grey*	08LG100UPAPDF5A
6	Design front, aluminium, RAL9003, for wall-integrated approach	08LG100WIDF

* for flush-mounted & surface solution, ceiling solution excepted.



1) RAL 9003 matt



2) Prisms



3) Line-art



4) Glass white



5) Glass grey

Wall-integrated version



Design front in RAL 9003 with flush wall finish



Variants of the outer wall elements

The different design variants of the outer wall elements allow for an integration into the modern architecture. Easy assembly with compact design. Available in V2A stainless steel or galvanized sheet steel and powder-coated in RAL 9003. Other colours on request.

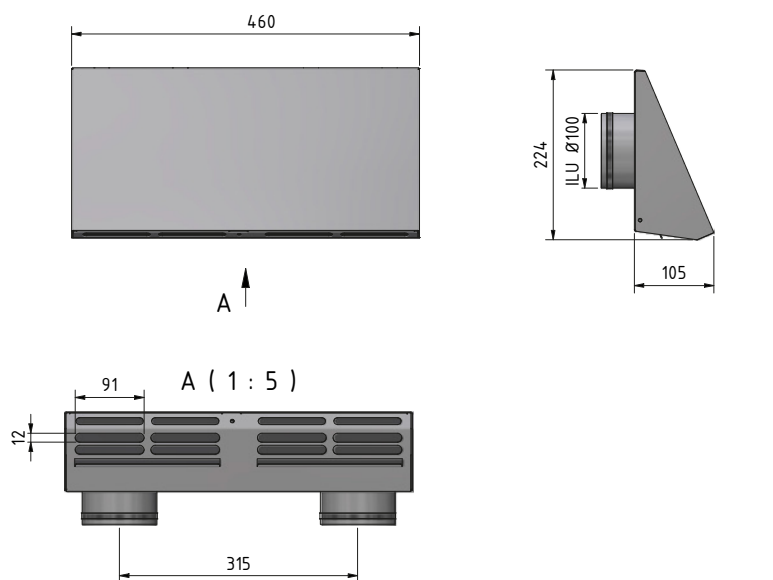

When using the ODA/EHA connecting piece DN100

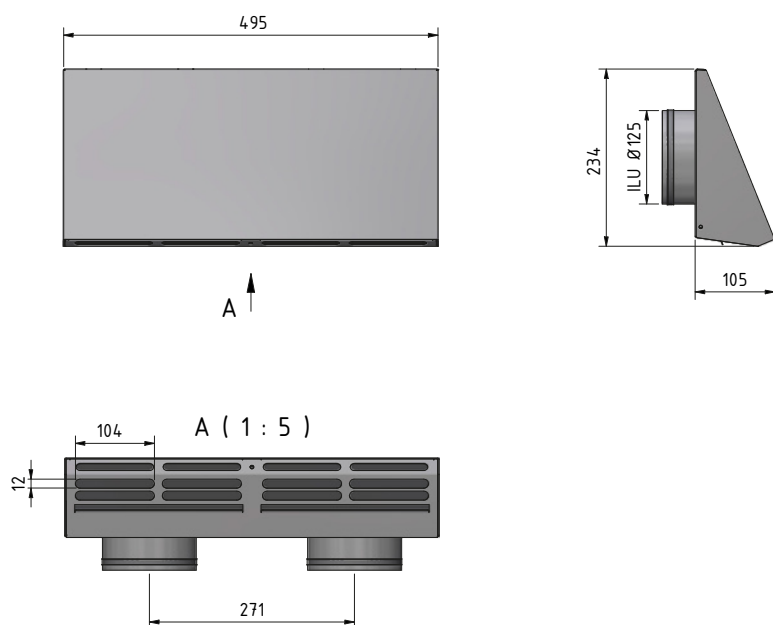

When using the EPP wall duct element



LG 100 at a glance!

- Decentralized ventilation unit with optional multi-room connections
- Moisture protection and comfort ventilation with heat recovery
- Flush-mounted, surface-mounted or ceiling installation
- Two-stage outdoor air filtration
- Without condensate drainage by enthalpy exchangers
- Silent and efficient
- VOC/eCO₂ multi-sensor for room air quality measurements integrated
- Operation via the Pichler App. The ventilation unit only supports the WiFi/WLAN standard 2.4 GHz.
- High acoustic insulation
- Intelligent moisture control



**ErP 2018**

Fulfills the requirements of the Ecodesign Directive, in accordance with EU Regulation 1253/2014.

**EPREL according to Regulation (EU) No. 1369/2017**

In accordance with VO (EU) No. 1369/2017 – Energy Labelling, European Product Database, the ventilation unit is listed in the EPREL database.



klimaaktiv
Partner

PASSIVHAUS
Austria

Mitglied
NETZWERK
PASSIVHAUS
www.passivhaus.at

Responsible for the content: J. Pichler Gesellschaft m.b.H. | Graphics and layout: WERK1 Werbegraphik GmbH
Photos: J. Pichler Gesellschaft m.b.H. | Text: J. Pichler Gesellschaft m.b.H.
All rights reserved | All photos are symbolic photos | Subject to change without notice | Version: 06/2025 en



Systematic ventilation.

J. PICHLER
Gesellschaft m.b.H.

AUSTRIA
9021 KLAGENFURT
AM WÖRTHSEE
Karlweg 5
T +43 (0)463 32769

1100 WIEN
Doerenkampgasse 5
T +43 (0)1 6880988

office@pichlerluft.at
www.pichlerluft.at

PICHLER
Lüftungstechnik G.m.b.H

GERMANY
86825 BAD WÖRISHOFEN
Altwaterstraße 23
office@pichlerluft.de
www.pichlerluft.de

PICHLER & CO d.o.o.
prezračevalni sistemi

SLOVENIA
2000 MARIBOR
Cesta k Tamu 26
T +386 (0)2 46013-50
pichler@pichler.si
www.pichler.si

KLIMA DOP d.o.o.
klimatizacija i ventilacija

SERBIA
11070 NOVI BEOGRAD
Autoput Beograd-Zagreb
bb (Blok 52 – prostor GP
„Novi Kolektiv“)
T +381 (0)11 3190177
office@klimadop.com
www.klimadop.com